

MARTIN COUNTY, STUART, FLORIDA
2401 S.E. MONTEREY ROAD PHONE NO. 772-288-5927

DWG. NAME : 21-023A.DWG | M.C. PROJ. NO. 21-023 | SHEET NO. 1 OF 3

EXHIBIT A

SURVEYOR'S NOTES

1. THIS SKETCH AND LEGAL DESCRIPTION IS BASED ON THE BOUNDARY SURVEY OF LOT 20 OF SUBDIVISION OF LOTS 13 AND 14 OF HANSON GRANT S/D, PREFORMED BY CHRISTIAN FENEX AND ASSOCIATES, LLC, SKETCH NUMBER 218079_LOT20-MC_2-11-2021.DWG, DATED 2/20/21 AND HANSON GRANT, ACCORDING TO THE PLAT THEREOF, RECORDED IN PLAT BOOK 1, PAGE 89, PUBLIC RECORDS OF PALM BEACH (NOW MARTIN) COUNTY, FLORIDA.
2. THIS LEGAL DESCRIPTION SHALL NOT BE VALID:
 - A. UNLESS PROVIDED IN ITS ENTIRETY CONSISTING OF SHEETS 1, 2 AND 3, SHEET 3 BEING A SKETCH.
 - B. WITHOUT THE SIGNATURE AND ORIGINAL RAISED SEAL OF A FLORIDA LICENSED SURVEYOR.
3. BEARING BASIS IS NORTH 46°10'12" WEST ALONG THE CENTERLINE OF SE KUBIN AVE, AS PER SAID BOUNDARY SURVEY AND ALL OTHERS ARE RELATIVE TO SAID BEARING.
4. THE PURPOSE OF THIS SKETCH AND DESCRIPTION IS TO DESCRIBE A PARCEL.
5. LANDS SHOWN HEREON WERE NOT ABSTRACTED FOR RIGHT-OF-WAY, EASEMENTS, OWNERSHIP, OR OTHER INSTRUMENTS OF RECORD.
6. THIS IS NOT A SURVEY AND DOES NOT DEFINE OWNERSHIP OR ENCROACHMENTS.
7. PROPERTY, TRACT, AND PARCEL LINES SHOWN ARE APPROXIMATE IN NATURE AND NOT TO BE RELIED UPON FOR LAND POSITIONING OR DETERMINATIONS.
8. ADDITIONS OR DELETIONS TO SURVEY MAPS OR REPORTS BY OTHER THAN THE SIGNING PARTY OR PARTIES IS PROHIBITED WITHOUT WRITTEN CONSENT OF THE SIGNING PARTY OR PARTIES.
9. LEGEND: C=CENTERLINE, ORB=OFFICIAL RECORDS BOOK, PB=PLAT BOOK, PCN=PARCEL CONTROL NUMBER, PG=PAGE, ROW=RIGHT-OF-WAY.

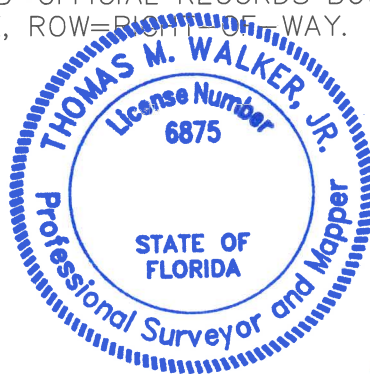

SURVEYOR AND MAPPER
IN RESPONSIBLE CHARGE

A handwritten signature in blue ink, appearing to read "T.M. Walker, Jr.", positioned above the printed name.

THOMAS M. WALKER, JR., P.S.M.
MARTIN COUNTY SURVEYOR
PROFESSIONAL SURVEYOR AND MAPPER
FLORIDA LICENSE NO. P.S.M. 6875

DATE: JUN 18 2021

THIS DOCUMENT MAY BE REPRODUCED UPON REQUEST IN AN ALTERNATIVE FORMAT BY CONTACTING THE COUNTY ADA COORDINATOR (772) 320-3131, THE COUNTY ADMINISTRATION OFFICE (772) 288-5400, FLORIDA RELAY 711, OR BY COMPLETING OUR ACCESSIBILITY FEEDBACK FORM AT WWW.MARTIN.FL.US/ACCESSIBILITY-FEEDBACK.

PUBLIC CONVSERVATION FUTURE LAND USE PARCEL
LOT 20 SUBDIVISION OF LOTS 13 AND 14 OF HANSON GRANT
MARTIN COUNTY, FLORIDA

SUPERVISED BY : MNM
DRAWN BY : JMM | SCALE : N/A
DATE : 6/10/2021
DRAWING # 21-023A

MARTIN COUNTY, STUART, FLORIDA
2401 S.E. MONTEREY ROAD PHONE NO. 772-288-5927

DWG. NAME : 21-023A.DWG | M.C. PROJ. NO. 21-023 | SHEET NO. 2 OF 3

EXHIBIT A

DESCRIPTION

LOT 20, SUBDIVISION OF LOTS 13 AND 14 HANSON GRANT, ACCORDING TO THE MAP OR PLAT THEREOF, AS RECORDED IN PLAT BOOK 1, PAGE(S) 89, OF THE PUBLIC RECORDS OF PALM BEACH (NOW MARTIN) COUNTY, FLORIDA.

LESS AND EXCEPT THE EAST 10 FEET OF THE ABOVE DESCRIBED PROPERTY.

AND

LESS AND EXCEPT THE SOUTHERLY 125 FEET OF THE EASTERLY 125 FEET OF THE ABOVE DESCRIBED PARCEL.

SAID PARCEL CONTAINS 216,839 SQUARE FEET, (4.98 ACRES) MORE OR LESS.

NOTE: THIS IS NOT A SURVEY. THIS SHEET IS NOT VALID WITHOUT SHEETS 1 AND 3.

<i>PUBLIC CONVSERVATION FUTURE LAND USE PARCEL</i> <i>LOT 20 SUBDIVISION OF LOTS 13 AND 14 OF HANSON GRANT</i> <i>MARTIN COUNTY, FLORIDA</i>	SUPERVISED BY : MNM	
	DRAWN BY : JMM	SCALE : N/A
	DATE : 6/10/2021	
	DRAWING # 21-023A	

