







LEGEND

-  AREA NOT INCLUDED IN PHASE REFLECTED ON THIS PLAN SHEET
-  EDGE OF WATER
-  PROPERTY BOUNDARY
-  RIGHT OF WAY
-  MULTI PURPOSE RECREATION TRAIL
-  LANDSCAPE BUFFER
-  PHASE LINE

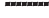

PHASING PLAN NOTES:

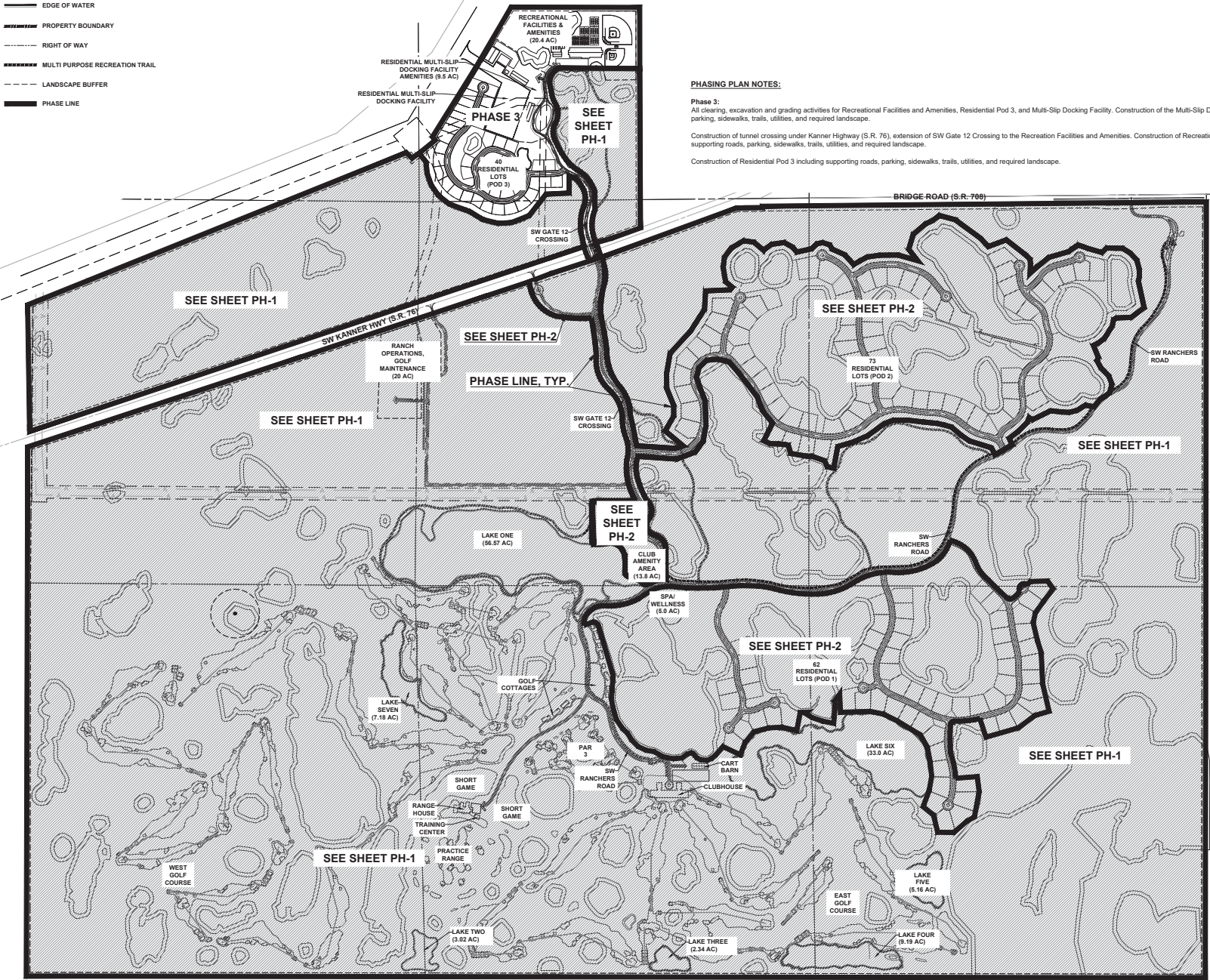
Phase 3:
 All clearing, excavation and grading activities for Recreational Facilities and Amenities, Residential Pod 3, and Multi-Slip Docking Facility. Construction of the Multi-Slip Docking Facility and supporting roads, parking, sidewalks, trails, utilities, and required landscape.
 Construction of tunnel crossing under Kanner Highway (S.R. 76), extension of SW Gate 12 Crossing to the Recreation Facilities and Amenities. Construction of Recreational Facilities and Amenities including supporting roads, parking, sidewalks, trails, utilities, and required landscape.
 Construction of Residential Pod 3 including supporting roads, parking, sidewalks, trails, utilities, and required landscape.



**Urban Design
 Land Planning
 Landscape Architecture**
 610 Clematis Street, Suite CU02
 West Palm Beach, FL 33401
 561.366.1100 FAX: 561.366.1111
 www.udsfirma.com
 #LA0001739

Copyright:
 All ideas, designs, arrangements, and plans represented by this drawing are owned by and the property of the designer, and were created for the exclusive use of the specified project. These ideas, designs, arrangements or plans shall not be used by, or disclosed to any person, firm, or corporation without the written permission of the designer.

The Ranch PUD

**Martin County, FL
 Phase 3 Plan**



NORTH

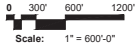

Scale: 1" = 600'-0"

Date: 04/09/2023
 Project No.: 21-124.000
 Designed By: RDLMB
 Drawn By: LMB
 Checked By: RD

Revision Dates:	
08/15/2023	RESUBMITTAL
09/06/2023	RESUBMITTAL
09/13/2024	RESUBMITTAL
09/27/2024	RESUBMITTAL

**PH-3
 of 3**