







LEGEND

-  AREA NOT INCLUDED IN PHASE REFLECTED ON THIS PLAN SHEET
-  EDGE OF WATER
-  PROPERTY BOUNDARY
-  RIGHT OF WAY
-  MULTI PURPOSE RECREATION TRAIL
-  LANDSCAPE BUFFER
-  PHASE LINE

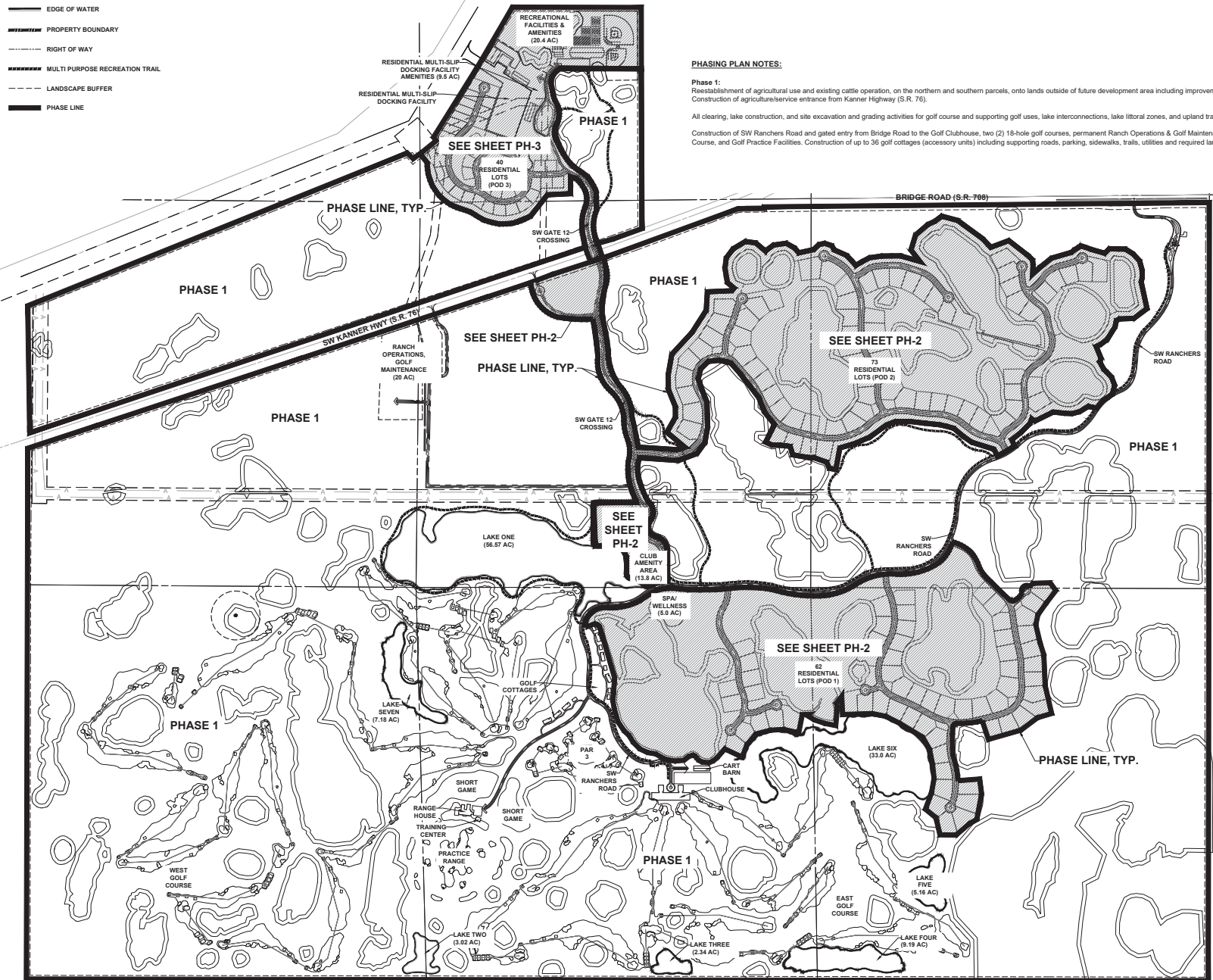

PHASING PLAN NOTES:

Phase 1:
 Reestablishment of agricultural use and existing cattle operation, on the northern and southern parcels, onto lands outside of future development area including improvements to existing buildings and structures.
 Construction of agriculture/service entrance from Kanner Highway (S.R. 76).

All clearing, lake construction, and site excavation and grading activities for golf course and supporting golf uses, lake interconnections, lake littoral zones, and upland transition areas for the southern parcel.
 Construction of SW Ranchers Road and gated entry from Bridge Road to the Golf Clubhouse, two (2) 18-hole golf courses, permanent Ranch Operations & Golf Maintenance Facility, Range House & Training Center, Par-3 Course, and Golf Practice Facilities. Construction of up to 36 golf cottages (accessory units) including supporting roads, parking, sidewalks, trails, utilities and required landscape.

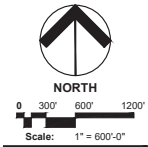







Date: 04/09/2023
 Project No.: 21-124.000
 Designed By: RDLMB
 Drawn By: LMB
 Checked By: RD

Revision Dates:

08/15/2023	RESUBMITTAL
09/06/2023	RESUBMITTAL
03/01/2024	RESUBMITTAL
03/27/2024	RESUBMITTAL

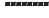
LEGEND

-  AREA NOT INCLUDED IN PHASE REFLECTED ON THIS PLAN SHEET
-  EDGE OF WATER
-  PROPERTY BOUNDARY
-  RIGHT OF WAY
-  MULTI PURPOSE RECREATION TRAIL
-  LANDSCAPE BUFFER
-  PHASE LINE

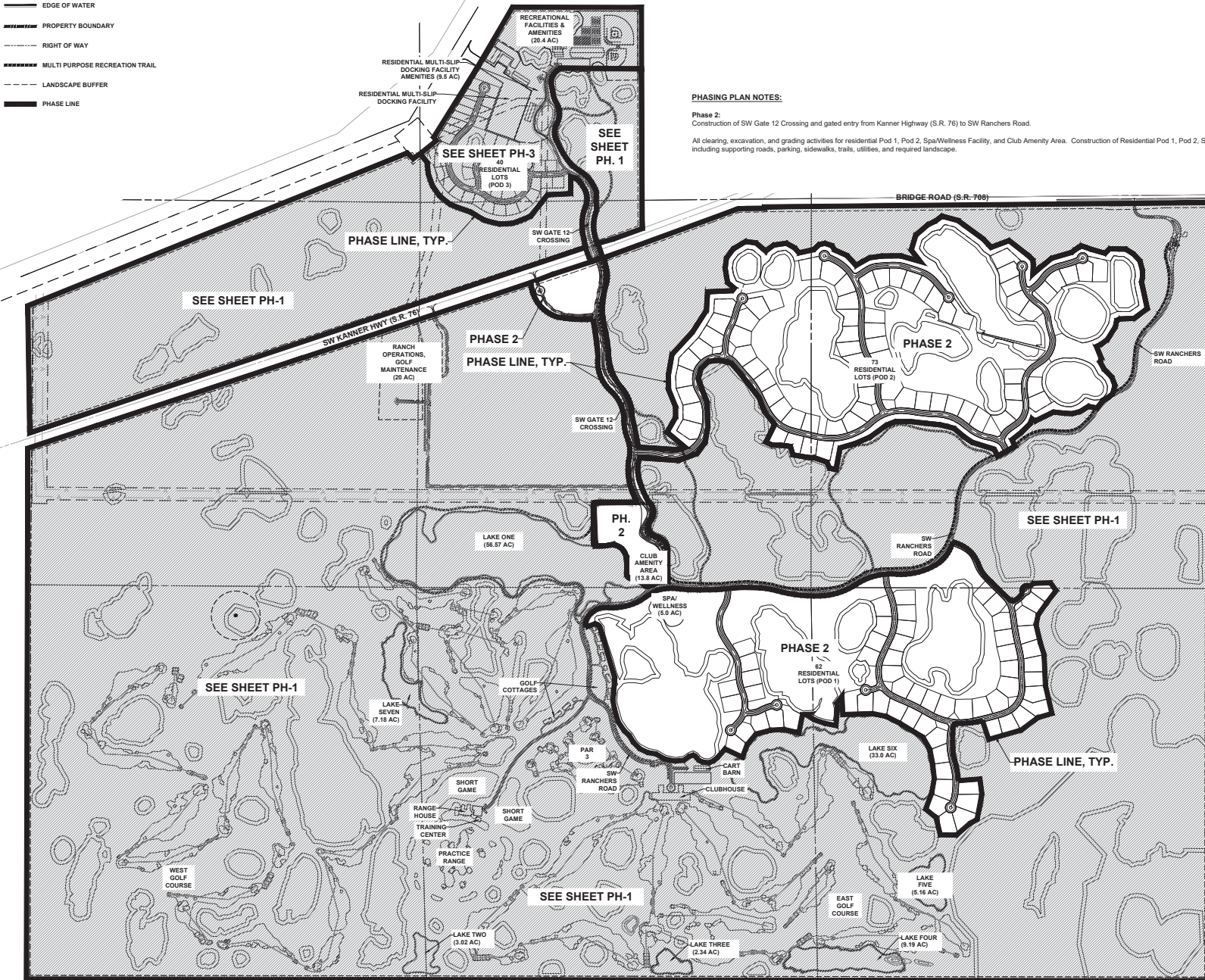

PHASING PLAN NOTES:

Phase 2:
Construction of SW Gate 12 Crossing and gated entry from Kanner Highway (S.R. 76) to SW Ranchers Road.

All clearing, excavation, and grading activities for residential Pod 1, Pod 2, Spa/Wellness Facility, and Club Amenity Area. Construction of Residential Pod 1, Pod 2, Spa/Wellness Facility, and Club Amenity Area including supporting roads, parking, sidewalks, trails, utilities, and required landscape.



**Urban Design
Land Planning
Landscape Architecture**

610 Clematis Street, Suite CU02
West Palm Beach, FL 33401
561.366.1100 FAX: 561.366.1111
www.udsfirma.com
#LA0001739

Copyright:
All ideas, designs, arrangements, and plans represented by this drawing are owned by and the property of the designer, and were created for the exclusive use of the specified project. These ideas, designs, arrangements or plans shall not be used by, or disclosed to any person, firm, or corporation without the written permission of the designer.

The Ranch PUD
Martin County, FL
Phase 2 Plan

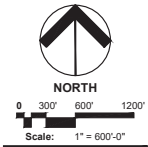







Date: 04/09/2023
Project No.: 21-124.000
Designed By: RDLMB
Drawn By: LMB
Checked By: RD

Revision Dates:

08/15/2023	RESUBMITTAL
09/06/2023	RESUBMITTAL
03/01/2024	RESUBMITTAL
03/27/2024	RESUBMITTAL

PH-2
of 3

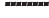
LEGEND

-  AREA NOT INCLUDED IN PHASE REFLECTED ON THIS PLAN SHEET
-  EDGE OF WATER
-  PROPERTY BOUNDARY
-  RIGHT OF WAY
-  MULTI PURPOSE RECREATION TRAIL
-  LANDSCAPE BUFFER
-  PHASE LINE

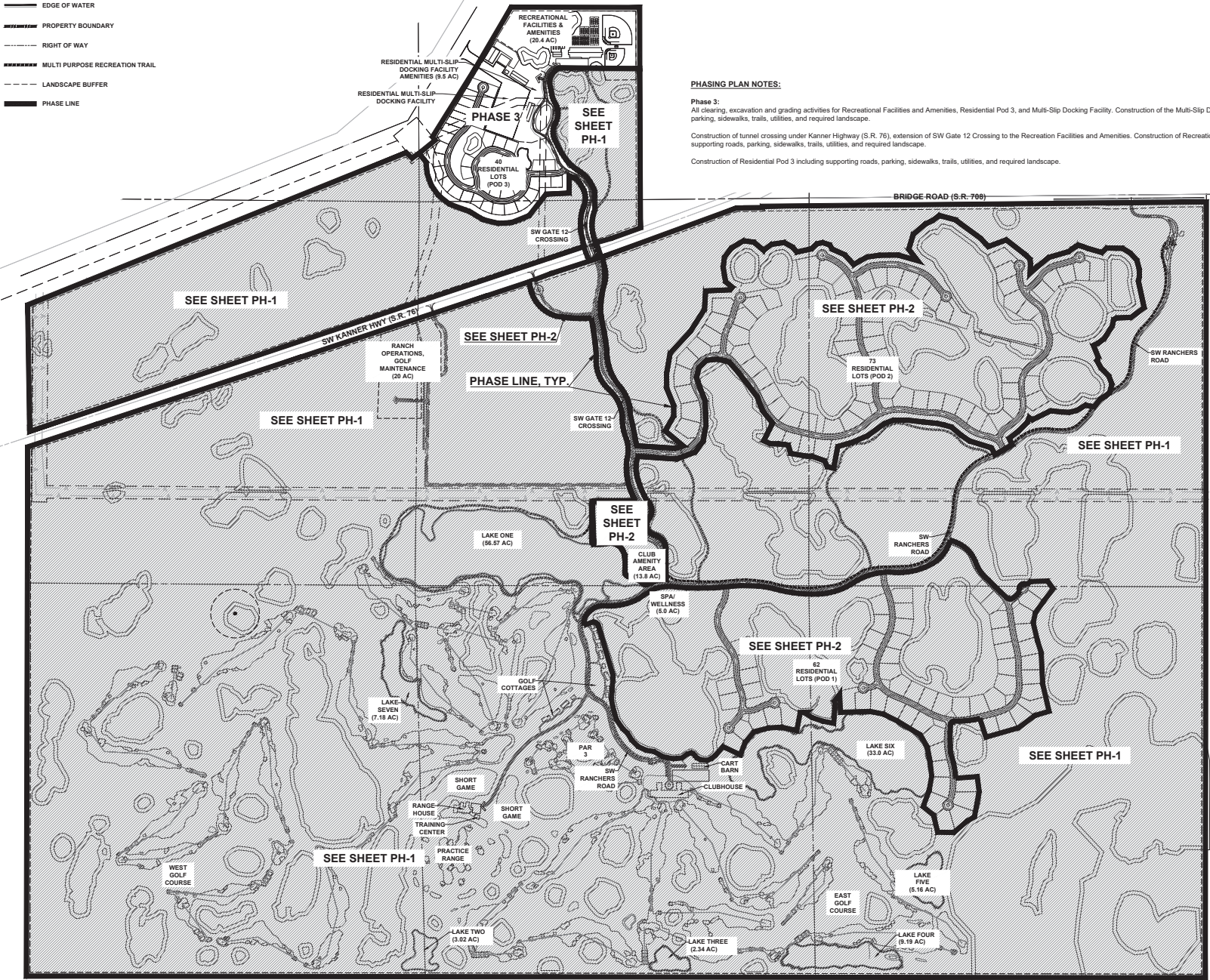

PHASING PLAN NOTES:

Phase 3:
 All clearing, excavation and grading activities for Recreational Facilities and Amenities, Residential Pod 3, and Multi-Slip Docking Facility. Construction of the Multi-Slip Docking Facility and supporting roads, parking, sidewalks, trails, utilities, and required landscape.
 Construction of tunnel crossing under Kanner Highway (S.R. 76), extension of SW Gate 12 Crossing to the Recreation Facilities and Amenities. Construction of Recreational Facilities and Amenities including supporting roads, parking, sidewalks, trails, utilities, and required landscape.
 Construction of Residential Pod 3 including supporting roads, parking, sidewalks, trails, utilities, and required landscape.

urban design studio
 Urban Design
 Land Planning
 Landscape Architecture
 610 Clematis Street, Suite CU02
 West Palm Beach, FL 33401
 561.366.1100 FAX: 561.366.1111
 www.udsfirma.com
 #LA0001739
 Copyright:
 All ideas, designs, arrangements, and plans represented by this drawing are owned by and the property of the designer, and were created for the exclusive use of the specified project. These ideas, designs, arrangements or plans shall not be used by, or disclosed to any person, firm, or corporation without the written permission of the designer.

The Ranch PUD
 Martin County, FL
 Phase 3 Plan
 11/03/2024 (revision) and 04/09/2023 (initial)

 NORTH
 0 300' 600' 1200'
 Scale: 1" = 600'-0"

Date: 04/09/2023
 Project No.: 21-124.000
 Designed By: RDLMB
 Drawn By: LMB
 Checked By: RD

Revision Dates:	REVISIONS:
08/15/2023	RESUBMITTAL
09/06/2023	RESUBMITTAL
09/10/2024	RESUBMITTAL
03/27/2024	RESUBMITTAL

PH-3
 of 3