



MARTIN COUNTY  
*Community Redevelopment Agency*

**GOLDEN GATE**

# LANDSCAPE VISION PLAN UPDATE

Golden Gate NAC –  
April 13, 2026





MARTIN COUNTY  
Community Redevelopment Agency

# NEIGHBORHOOD MAP





MARTIN COUNTY  
Community Redevelopment Agency

# DIXIE HIGHWAY MEDIANS

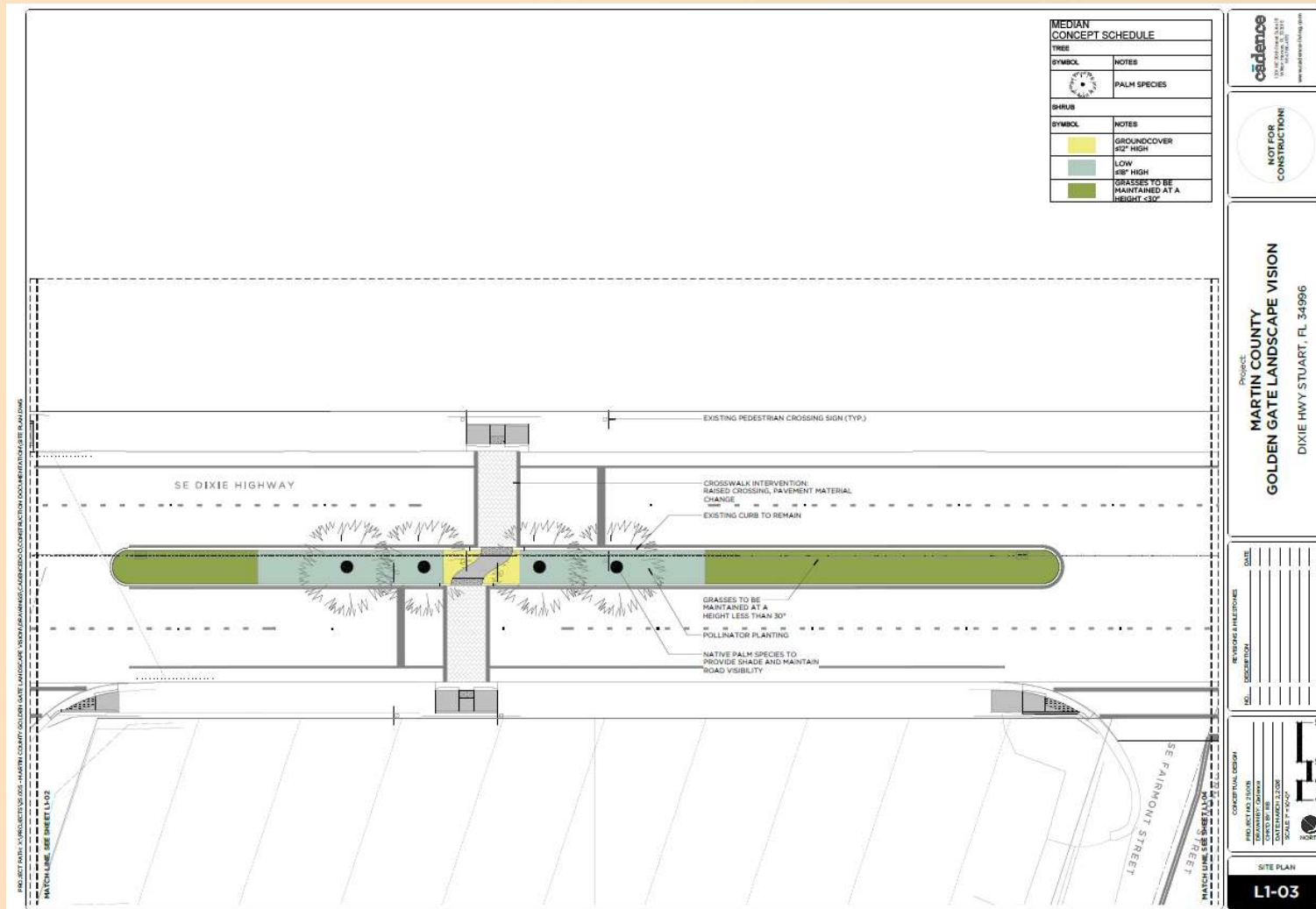

MEDIAN CONCEPT SCHEDULE	
TREE	
SYMBOL	NOTES
	PALM SPECIES
SHRUB	
SYMBOL	NOTES
	GROUNDCOVER 41/2" HIGH
	LOW SHRUB 41/2" HIGH
	GRASSES TO BE MAINTAINED AT A HEIGHT <30"



PROJECT: MARTIN COUNTY  
GOLDEN GATE LANDSCAPE VISION  
DIXIE HWY STUART, FL 34996

DATE	DESCRIPTION



SITE PLAN  
**L1-03**



# SIDE STREET LANDSCAPING

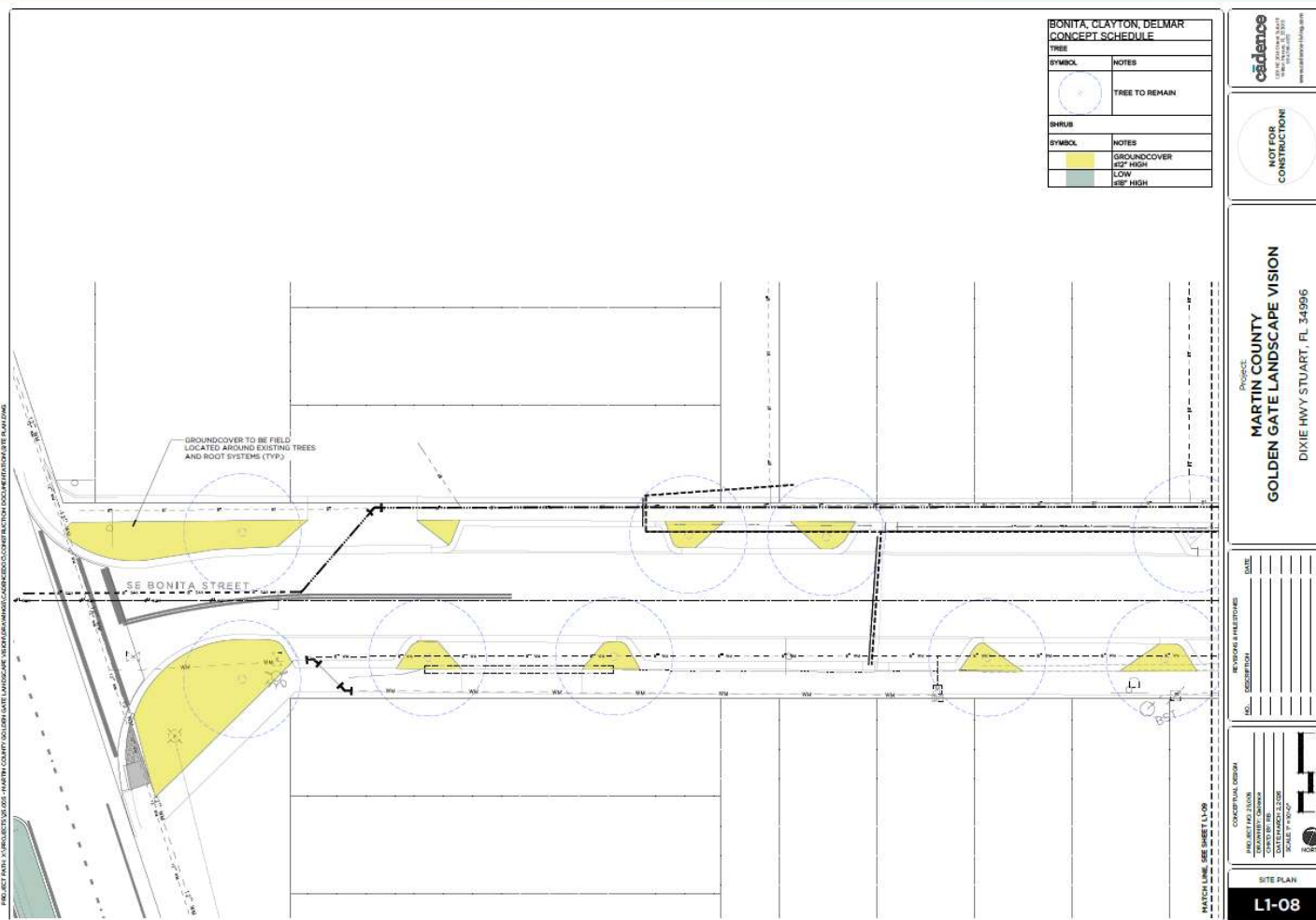

**MARTIN COUNTY**  
Community Redevelopment Agency



MARTIN COUNTY  
Community Redevelopment Agency

# BIRCH AVENUE POCKET PARK



POCKET PARK CONCEPT SCHEDULE	
TREE	
SYMBOL	NOTES
	MEDIUM OR LARGE TREE SPECIES
	SMALL OR MEDIUM TREE SPECIES
	PALM SPECIES
	PINE SPECIES
	TREE TO REMAIN
	PALM TO REMAIN
	PINE TO REMAIN
SHRUB	
SYMBOL	NOTES
	HIGH 8-30' HIGH
	MEDIUM 4-8' HIGH
	LOW 2-4' HIGH
	GROUNDCOVER
	GRASSES
	LAWN
	MULCH 2" MIN DEPTH
SITE ELEMENTS	
SYMBOL	NOTES
	BOULDER 3' MIN. DIAMETER HEIGHTS VARY 8"-30"
	STUMPS 2" MIN. DIAMETER HEIGHTS VARY 8"-24"
	TRASH RECEPTACLES
	6' HIGH FENCE

Project: **MARTIN COUNTY GOLDEN GATE LANDSCAPE VISION**  
DIXIE HWY STUART, FL 34996

---

REVISIONS

NO.	DESCRIPTION	DATE

---

CONCEPTUAL DESIGN

DATE: 11/15/2024  
 DRAWN BY: J. BROWN  
 CHECKED BY: J. BROWN  
 SCALE: 1/8"=1'-0"

---

SITE PLAN

**L1-14**



**MARTIN COUNTY**  
*Community Redevelopment Agency*

# QUESTIONS?

**Joy Puerta**  
**Office of Community Development**

☎ 772-288-5908

✉ [jpuerta@martin.fl.us](mailto:jpuerta@martin.fl.us)