

Hobe Hills Neighborhood Restoration Revised 6/6/2022

Category	Non-concurrency
Project Number	101759/ARPASW1
Location	Hobe Sound
District	Three

Project Limits Hobe Hills Subdivision

Related Projects	
Lead Dept/Division	Public Works/Capital Projects
Year Project Initiated	2017

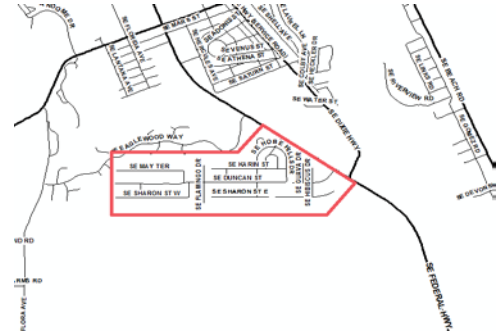

DESCRIPTION

The Infrastructure Reinvestment project includes the replacement of drainage structures, regrading of drainage swales, pavement milling, resurfacing, replacement of sidewalks, and other ancillary items within the neighborhood. This project completes the neighborhood restoration of the Hobe Hills subdivision.

BACKGROUND

In FY 16 the Board appropriated \$5.4M in Ad Valorem and \$9M in Franchise Fees to reduce the infrastructure backlog. There are several areas of the neighborhood with a poor drainage health index and low pavement rating.

PROJECT ORIGINATION

Infrastructure Needs

JUSTIFICATION

Policy 14.1A.10 of the Comprehensive Growth Management Plan has requirements to "(1) identify projects that eliminate public hazards; and (2) repair, remodeling, renovation or replacement of obsolete or worn out facilities that contribute to achieving or maintaining standards for levels of service."

				Funded					Unfunded	
Expenditures	Total	To Date		FY22	FY23	FY24	FY25	FY26	FY27-FY31	
Design	130,000	130,000								
Construction	2,150,000			2,150,000						
Expenditure Total	2,280,000	130,000		2,150,000	0	0	0	0	0	
Revenues	Total	To Date	Carryover	FY22	FY23	FY24	FY25	FY26	FY27-FY31	
Road MSTU	130,000	130,000								
ARPA Infrastructure	1,200,000			1,200,000						
FPL Franchise Fee	575,000		575,000							
Ad Valorem	375,000		375,000							
Revenue Total	2,280,000	130,000	950,000	1,200,000	0	0	0	0	0	
						Total Unfunded				0

OPERATING BUDGET IMPACT

Maintenance costs during the first five years after drainage replacement, resurfacing and restriping will be minimal;

Drainage structures installed have a 50-100 year life cycle;

Resurfaced asphalt pavement will have a 25-30 year cycle at \$125,000/mile