

Tree #	Common Name	Size (DBH)	Protected	Status	Preserve Credits	Replacement Credits
1	Gumbo Limbo	28	Yes	Remain	5	
2	Sabal Palm	11.5	No	Remain		
3	Sabal Palm	11.5	No	Remain		
4	Sabal Palm	11.5	No	Remain		
5	Sabal Palm	9.5	No	Remain		
6	Sabal Palm	9.5	No	Remain		
7	Sabal Palm	9.5	No	Remain		
8	Triple Adonidia Palm	3	No	Remain		
9	Oak	21	Yes	Remain	5	
10	Queen Palm	11	No	Remove		
11	Queen Palm	11	No	Remove		
12	Queen Palm	11	No	Remove		
13	Sabal Palm	9.5	No	Remain		
14	Sabal Palm	9.5	No	Remain		
15	Sabal Palm	9.5	No	Remain		
16	Sabal Palm	11	No	Remain		
17	Sabal Palm	11	No	Remain		
18	Sabal Palm	11	No	Remain		
19	Ribbon Palm	9.5	No	Remain		
20	Queen Palm	9.5	No	Remain		
21	Ribbon Palm	9.5	No	Remain		
22	Ribbon Palm	9.5	No	Remain		
23	Triple Adonidia Palm	2.5	No	Remain		
24	Sabal Palm	9.5	No	Remain		
25	Sabal Palm	9.5	No	Remain		
26	Sabal Palm	9.5	No	Remain		
27	Triple Adonidia Palm	5	No	Remove		
28	Triple Adonidia Palm	5	No	Remove		
29	Triple Adonidia Palm	5	No	Remove		
30	Sabal Palm	11	No	Remain		
31	Sabal Palm	11	No	Remain		
32	Sabal Palm	11	No	Remove		
33	Roadbeleni Palm	2.5	No	Remove		
34	Roadbeleni Palm	2.5	No	Remove		
35	Roadbeleni Palm	2.5	No	Remove		
36	Roadbeleni Palm	2.5	No	Remove		
37	Roadbeleni Palm	2.5	No	Remove		
38	Roadbeleni Palm	3	No	Remove		
39	Roadbeleni Palm	2.5	No	Remove		
40	Sabal Palm	11	No	Remain		
41	Sabal Palm	11	No	Remain		
42	Sabal Palm	11	No	Remove		
43	Roadbeleni Palm	3	No	Remove		
44	Double Adonidia Palm	4	No	Remain		
45	Bottle Palm	13	No	Remain		
46	Sabal Palm	9.5	No	Remain		
47	Sabal Palm	9.5	No	Remain		
48	Sabal Palm	9.5	No	Remain		
49	Sabal Palm	9.5	No	Remain		
50	Sabal Palm	9.5	No	Remain		
51	Sabal Palm	9.5	No	Remain		
52	Sabal Palm	11	No	Remain		
53	Sabal Palm	11	No	Remain		
54	Sabal Palm	11	No	Remain		
55	Sabal Palm	11	No	Remain		
56	Sabal Palm	11	No	Remain		
57	Sabal Palm	11	No	Remain		
58	Sabal Palm	11	No	Remain		
59	Triple Adonidia Palm	5	No	Remain		
60	Triple Adonidia Palm	5	No	Remain		
61	Sabal Palm	11	No	Remain		
62	Sabal Palm	11	No	Remain		
63	Sabal Palm	11	No	Remain		
64	Sabal Palm	11	No	Remain		
65	Sabal Palm	11	No	Remain		
66	Sabal Palm	11	No	Remain		
67	Bottle Palm	13	No	Remain		
68	Bottle Palm	13	No	Remain		
69	Sabal Palm	9.5	No	Remove		
70	Ribbon Palm	9.5	No	Remove		
71	Sabal Palm	9.5	No	Remove		
72	Sabal Palm	9.5	No	Remove		
73	Ribbon Palm	9.5	No	Remove		
Total					11	0

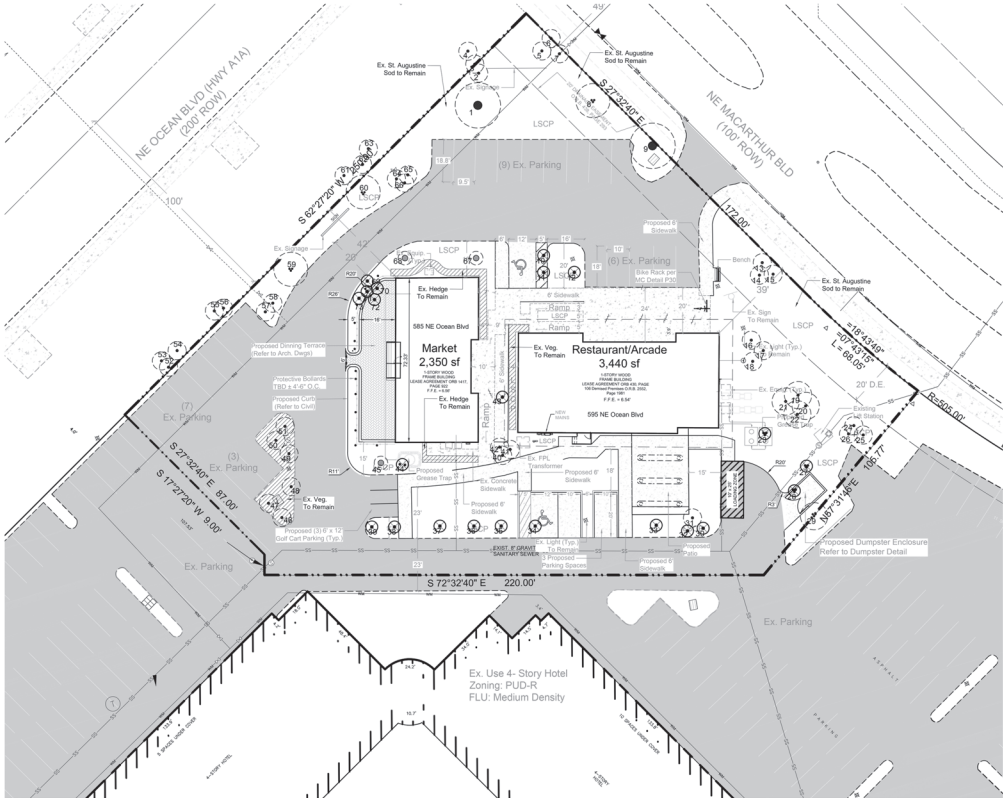

50 E. Ocean Blvd., Suite 101
Stuart, Florida 34994
T 772.678.7200
F 772.678.7201
www.jadesignstudio.com
LA 0000905

Indian River Plantation PUD 19th Amendment
Florida
Martin County
Revised Phase 3 Final Site Plan - Ex. Tree / Removal Plan

Copyright © 2021 J.A. Design Studio, Inc. All rights reserved. This drawing is the property of J.A. Design Studio, Inc. and is not to be reproduced, stored in a retrieval system, or transmitted in any form or by any means, electronic, mechanical, photocopying, recording, or by any information storage and retrieval system, without the prior written permission of J.A. Design Studio, Inc. The user of this drawing assumes all liability for the use of this drawing. The user of this drawing warrants that it is the user's property and that it is not to be reproduced, stored in a retrieval system, or transmitted in any form or by any means, electronic, mechanical, photocopying, recording, or by any information storage and retrieval system, without the prior written permission of J.A. Design Studio, Inc. The user of this drawing warrants that it is the user's property and that it is not to be reproduced, stored in a retrieval system, or transmitted in any form or by any means, electronic, mechanical, photocopying, recording, or by any information storage and retrieval system, without the prior written permission of J.A. Design Studio, Inc.

Tree Barricade Detail

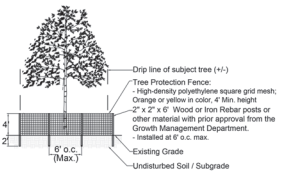

Tree Protection Notes

- Existing trees that are to be preserved shall be barricaded according to Martin County regulations.
- Tree Protection Barricades shall be erected prior to the commencement of any work. All barricades must be maintained intact for the duration of construction.
- Barricades must be constructed around the critical protection zone of each tree or cluster of trees.
- During periods of development and construction, the areas within the drip-line of preserved trees shall be maintained at their original grade with pervious landscape material. Within these areas, there shall be:
 - No trenching or cutting of roots
 - No fill, compaction or removal of soil; and
 - No use of concrete, paint, chemicals or other foreign substances
- Barricades shall be constructed of a yellow or orange high density polyethylene square grid mesh fence with a min. height of 4 feet. Fencing shall be secured to posts with nylon cable ties at the top, middle, and bottom of each post. Posts shall be 2\"/>

General LSCP Notes

- Encroachments into required buffer yards and landscape areas by vehicles, boats, mobile homes or trailers shall not be permitted and required landscape areas shall not be used for the storage or sale of materials or products or the parking of vehicle and equipment.
- Alternative plant species for required landscape may be permitted subject to review and approval by Martin County Growth Management Department prior to installation.
- All prohibited exotic or invasive species shall be removed from the site prior to the issue of a certificate of occupancy.
- No cypress mulch is to be used on site. Eucalyptus or metaleuca mulch is to be used in a 3\"/>

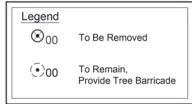

Scale: 1" = 20'



Job No. 2021-47
Drawn By EB
Checked By MH
Approved By MH
Submittal Dates
Original Submittal (06-07-22)
Round 2 Submittal (03-30-23)
Round 3 Submittal (05-09-23)

LP-1

Total Developed Area (SF)	50,803	
	<u>Required</u>	<u>Provided</u>
Area (SF)	10,161	18,187

	<u>Required</u>	<u>Provided</u>
Trees	20	45
		(2 Ex. Trees + 23 Trees + 2

Sec. 4.663.A.4. b - "In vehicular use areas within the interior of a site, one 500 SF planting area shall be required for every 5,000 SF of vehicular use area, or major portion thereof, and at least 3 2", or 2 3" caliper shade trees together with other landscape material. Median parking islands shall have 1 tree for every 100

LF ²	Total VUA Area (SF)	21,131	
		<u>Required</u>	<u>Provided</u>

Trees (2) 3" Caliper per 5,000sf 8 32
(17 Trees + 2 Palms @ 1:1 +
9 Palms @ 3:1 + 1 Ex. Tree =

	<u>Required</u>	<u>Provided</u>
Parking Island Trees	11	12
		(1 Ex. Tree + 7 Trees + 1 Ex.

Total Trees	20	44
Total Native(75%)	15	15

(2 Ex. Trees + 10 Trees

			+ 9 Palms @ 3:1
Total Shade Trees Required (50%)	10	12	(2 Ex. Trees + 10 Trees)

