

**BEFORE THE BOARD OF COUNTY COMMISSIONERS
MARTIN COUNTY, FLORIDA
DEVELOPMENT ORDER**

RESOLUTION NUMBER _____

**[REGARDING DENIAL OF REVISED MASTER AND PHASE 2 FINAL SITE PLAN
APPROVAL FOR MARINER VILLAGE SQUARE PUD**

WHEREAS, this Board has made the following determinations of fact:

1. Ribbin Ventures, LLC. submitted an application for a Revised PUD master and phase 2 Final site plan for the Mariner Village Square project, located on lands legally described in Exhibit A, attached hereto.
2. This Board held a public meeting on the application on February 25, 2020.
3. At the public meeting, all interested parties were given an opportunity to be heard.

NOW, THEREFORE, BE IT RESOLVED BY THE BOARD OF COUNTY COMMISSIONERS OF MARTIN COUNTY, FLORIDA, THAT:

- A. The request for a Revised master and phase 2 Final Site Plan for the Mariner Village Square PUD project is denied because XXXXX.
- B. This resolution shall be recorded in the public records of Martin County. A copy of this resolution shall be forwarded to the applicant(s) by the Growth Management Department subsequent to recording.

DULY PASSED AND ADOPTED THIS 25TH DAY OF FEBRUARY, 2020.

ATTEST:

BOARD OF COUNTY COMMISSIONERS
MARTIN COUNTY, FLORIDA

BY: _____
CAROLYN TIMMANN
CLERK OF THE CIRCUIT COURT
AND COMPTROLLER

BY: _____
HAROLD E. JENKINS, CHAIRMAN

APPROVED AS TO FORM AND LEGAL
SUFFICIENCY:

BY: _____
KRISTA A. STOREY
SENIOR ASSISTANT COUNTY ATTORNEY

ATTACHMENTS:

Exhibit A, Legal Description

Exhibit "A"
Legal Description

Lot 25 of the Plat of THE ELLIPSE, according to the Plat thereof as recorded in Plat Book 11 at Page 84 of the Public Records of Martin County, Florida.

Total Acreage: 8.34

PCN: 05-39-41-002-000-00250-6

Exhibit "B"

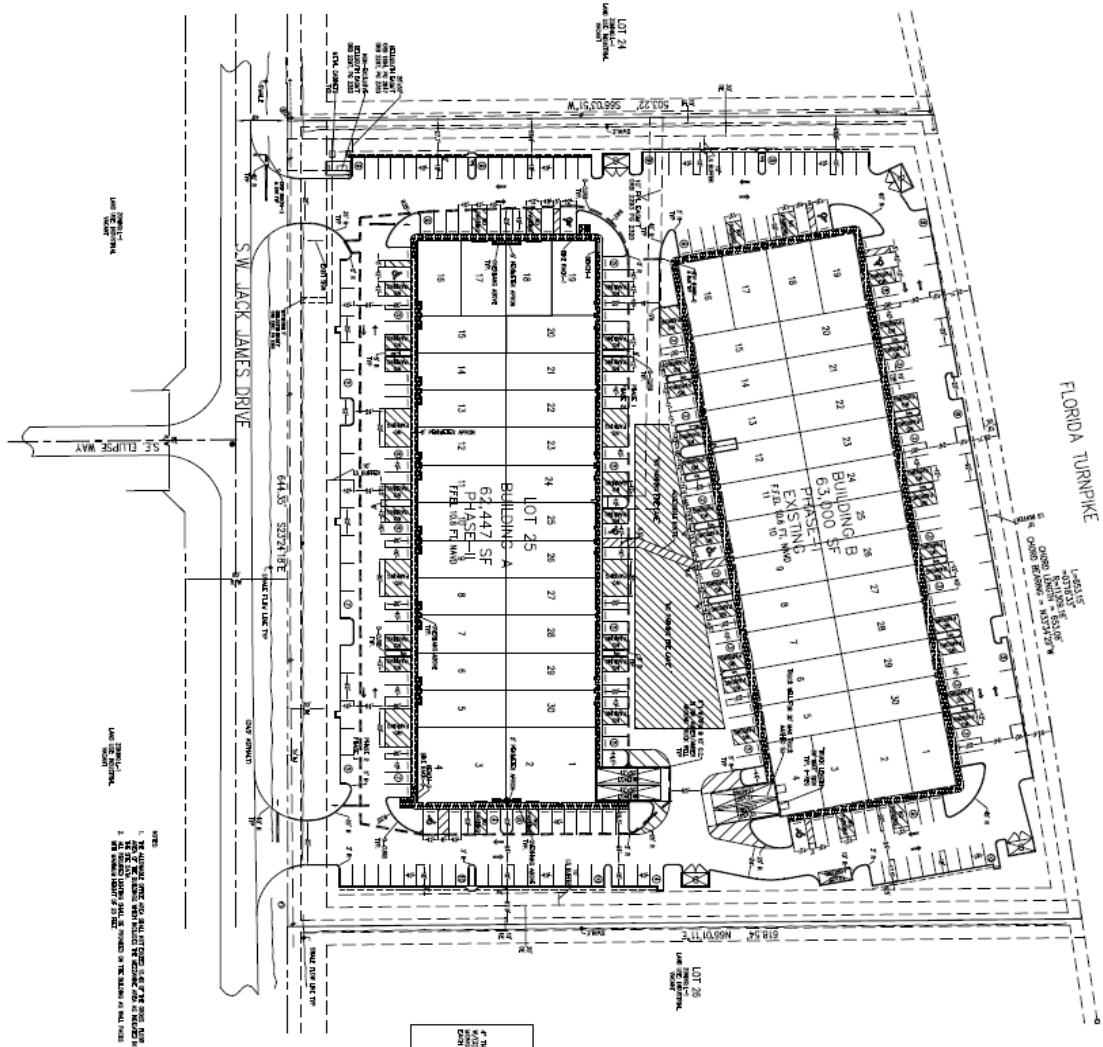
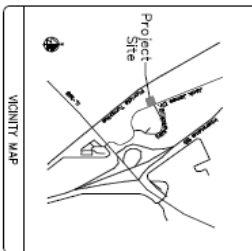
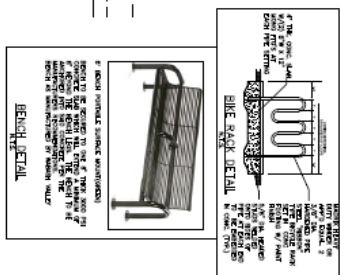
[illegible]

LEADING	
1	DRY MEAT & FISH
2	CHICKEN, TURKEY & Poultry
3	BEVERAGES
4	MEATS
5	SEASONING & SPICES
6	TYPE OF CANS
7	TYPE OF CANS
8	DATE OF PREPARED
9	DATE OF PREPARED
10	DATE OF PREPARED
11	DATE OF PREPARED
12	DATE OF PREPARED
13	DATE OF PREPARED
14	DATE OF PREPARED
15	DATE OF PREPARED
16	DATE OF PREPARED
17	DATE OF PREPARED
18	DATE OF PREPARED
19	DATE OF PREPARED
20	DATE OF PREPARED
21	DATE OF PREPARED
22	DATE OF PREPARED
23	DATE OF PREPARED
24	DATE OF PREPARED
25	DATE OF PREPARED
26	DATE OF PREPARED
27	DATE OF PREPARED
28	DATE OF PREPARED
29	DATE OF PREPARED
30	DATE OF PREPARED
31	DATE OF PREPARED
32	DATE OF PREPARED
33	DATE OF PREPARED
34	DATE OF PREPARED
35	DATE OF PREPARED
36	DATE OF PREPARED
37	DATE OF PREPARED
38	DATE OF PREPARED
39	DATE OF PREPARED
40	DATE OF PREPARED
41	DATE OF PREPARED
42	DATE OF PREPARED
43	DATE OF PREPARED
44	DATE OF PREPARED
45	DATE OF PREPARED
46	DATE OF PREPARED
47	DATE OF PREPARED
48	DATE OF PREPARED
49	DATE OF PREPARED
50	DATE OF PREPARED
51	DATE OF PREPARED
52	DATE OF PREPARED
53	DATE OF PREPARED
54	DATE OF PREPARED
55	DATE OF PREPARED
56	DATE OF PREPARED
57	DATE OF PREPARED
58	DATE OF PREPARED
59	DATE OF PREPARED
60	DATE OF PREPARED
61	DATE OF PREPARED
62	DATE OF PREPARED
63	DATE OF PREPARED
64	DATE OF PREPARED
65	DATE OF PREPARED
66	DATE OF PREPARED
67	DATE OF PREPARED
68	DATE OF PREPARED
69	DATE OF PREPARED
70	DATE OF PREPARED
71	DATE OF PREPARED
72	DATE OF PREPARED
73	DATE OF PREPARED
74	DATE OF PREPARED
75	DATE OF PREPARED
76	DATE OF PREPARED
77	DATE OF PREPARED
78	DATE OF PREPARED
79	DATE OF PREPARED
80	DATE OF PREPARED
81	DATE OF PREPARED
82	DATE OF PREPARED
83	DATE OF PREPARED
84	DATE OF PREPARED
85	DATE OF PREPARED
86	DATE OF PREPARED
87	DATE OF PREPARED
88	DATE OF PREPARED
89	DATE OF PREPARED
90	DATE OF PREPARED
91	DATE OF PREPARED
92	DATE OF PREPARED
93	DATE OF PREPARED
94	DATE OF PREPARED
95	DATE OF PREPARED
96	DATE OF PREPARED
97	DATE OF PREPARED
98	DATE OF PREPARED
99	DATE OF PREPARED
100	DATE OF PREPARED

STPL
JST H 254V-MQ 7C
PL NO 00225
CPL 15598
JST NO.
6412-848
SHEET NO.
MSP-1

MASTER SITE PLAN			
DATE 7/23/05	SCALE 1"=40'	DESIGNED BY JHC	DRAWN BY ZAK

**TREASURE COAST
COMMERCE CENTER
(LOT 25 ELLIPSE)**

MARTIN COUNTY, FLORIDA

Jeff H. Irvani, Inc.
Consulting Engineers
1934 COMMENCE LANE, SUITE 5
JUPITER, FLORIDA 33458
TEL: (561) 575-6030
FAX: (561) 575-6088
JHI@earthlink.net

[illegible]

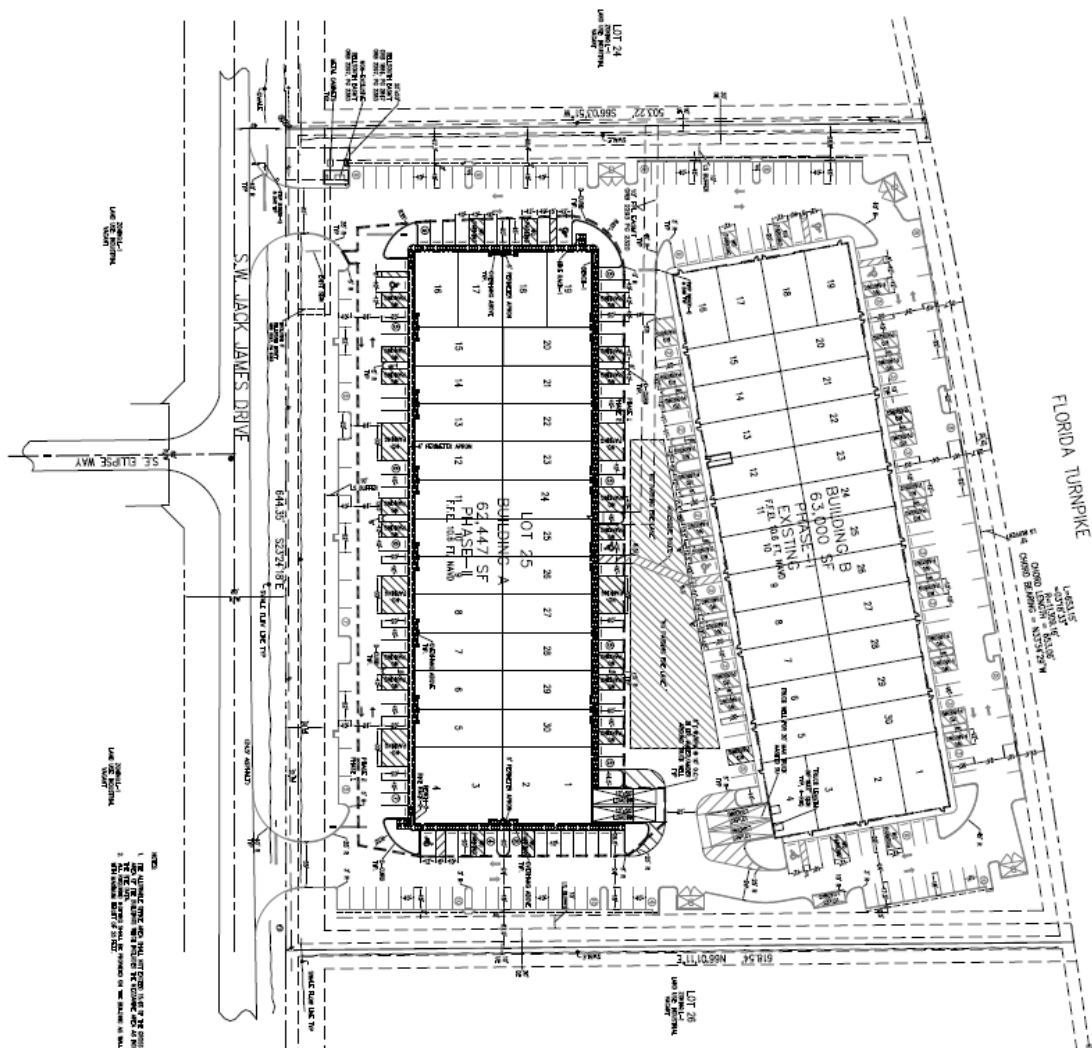
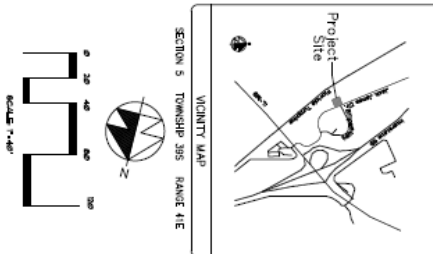
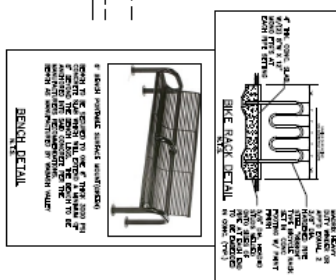
[illegible]

DATE 7/28/05		SCALE 1"=40'		DRAWN BY J-D	
CHECKED BY SP-1				DRAWN BY ZAK	

**TREASURE COAST
COMMERCE CENTER**
(LOT 25 ELLIPSE)
PHASE II
MARTIN COUNTY, FLORIDA

Jeff H. Iravani, Inc.
Consulting Engineers

1934 COMMERCIAL LANE, SUITE 5
JUPITER, FLORIDA 33408

TEL: (561) 575-6030
FAX: (561) 575-6068

JH.Ir@earthlink.net

[illegible]

