

MARTIN COUNTY, STUART, FLORIDA
2401 S.E. MONTEREY ROAD PHONE NO. 772-288-5927

DWG. NAME : 20-007C.DWG | M.C. PROJ. NO. 20-007C | SHEET NO. 1 OF 5

SURVEYOR'S NOTES

1. THIS SKETCH AND LEGAL DESCRIPTION IS BASED ON THE LIMITS OF THE GOLDEN GATE CRA.
2. THIS LEGAL DESCRIPTION SHALL NOT BE VALID:
 - A. UNLESS PROVIDED IN ITS ENTIRETY CONSISTING OF SHEETS 1, 2, 3, 4 AND 5, SHEET 5 BEING A SKETCH.
 - B. WITHOUT THE ORIGINAL SIGNATURE AND RAISED SEAL OF A FLORIDA LICENSED SURVEYOR.
3. THE PURPOSE OF THIS SKETCH AND DESCRIPTION IS TO DESCRIBE THE LIMITS OF THE GOLDEN GATE CRA.
4. LANDS SHOWN HEREON WERE NOT ABSTRACTED FOR RIGHT-OF-WAY, EASEMENTS, OWNERSHIP, OR OTHER INSTRUMENTS OF RECORD.
5. THIS IS NOT A SURVEY AND DOES NOT DEFINE OWNERSHIP OR ENCROACHMENTS.
6. PROPERTY, TRACT, AND PARCEL LINES SHOWN ARE APPROXIMATE IN NATURE AND NOT TO BE RELIED UPON FOR LAND POSITIONING OR DETERMINATIONS.
7. ADDITIONS OR DELETIONS TO SURVEY MAPS OR REPORTS BY OTHER THAN THE SIGNING PARTY OR PARTIES IS PROHIBITED WITHOUT WRITTEN CONSENT OF THE SIGNING PARTY OR PARTIES.
8. LEGEND: CRA=COMMUNITY REDEVELOPMENT AGENCY, F.E.C.=FLORIDA EAST COAST, POB=POINT OF BEGINNING.

THIS DOCUMENT MAY BE REPRODUCED UPON REQUEST IN AN ALTERNATIVE FORMAT BY CONTACTING THE COUNTY ADA COORDINATOR (772) 320-3131, THE COUNTY ADMINISTRATION OFFICE (772) 288-5400, FLORIDA RELAY 711, OR BY COMPLETING OUR ACCESSIBILITY FEEDBACK FORM AT WWW.MARTIN.FL.US/ACCESSIBILITY-FEEDBACK.

NOTE: THIS IS NOT A SURVEY. THIS SHEET IS NOT VALID WITHOUT SHEETS 2, 3, 4 AND 5.

**SURVEYOR AND MAPPER
IN RESPONSIBLE CHARGE**

THOMAS M. WALKER, JR., P.S.M.
MARTIN COUNTY SURVEYOR
PROFESSIONAL SURVEYOR AND MAPPER
FLORIDA LICENSE NO. P.S.M. 6875

DATE: 10/15/2020

SKETCH AND DESCRIPTION
GOLDEN GATE CRA - BOUNDARY
MARTIN COUNTY, FLORIDA

SUPERVISED BY : TMW	
DRAWN BY : JMM	SCALE : N/A
DATE : 10/14/2020	
DRAWING # 20-007C	

MARTIN COUNTY, STUART, FLORIDA

2401 S.E. MONTEREY ROAD PHONE NO. 772-288-5927

DWG. NAME : 20-007C.DWG M.C. PROJ. NO. 20-007C SHEET NO. 2 OF 5

DESCRIPTION

A PORTION OF LAND LYING IN THE FOLLOWING PLATS: GOLDEN GATE PARK, AS RECORDED IN PLAT BOOK 1, PAGES 50, 50A, 50B, AND 50C, PUBLIC RECORDS OF MARTIN COUNTY, FLORIDA; GOLDEN GATE, AS RECORDED IN PLAT BOOK 11, PAGE 41, PUBLIC RECORDS OF PALM BEACH (NOW MARTIN) COUNTY, FLORIDA; AND PORT SEWALL, ACCORDING TO THE OFFICIAL MAP SEWALL'S POINT LAND COMPANY REVISED, AS RECORDED IN PLAT BOOK 3, PAGE 8, PUBLIC RECORDS OF PALM BEACH (NOW MARTIN) COUNTY, FLORIDA.

BEING MORE PARTICULARLY DESCRIBED AS FOLLOWS:

BEGIN AT THE SOUTHEASTERN CORNER OF BLOCK 223, GOLDEN GATE PARK, ACCORDING TO SAID PLAT THEREOF; THENCE SOUTHWESTERLY ALONG THE SOUTHERLY LINE OF SAID BLOCK 223 AND ITS SOUTHWESTERLY PROJECTION TO THE EASTERLY RIGHT-OF-WAY LINE OF THE FLORIDA EAST COAST (F.E.C.) RAILROAD (A 100 FOOT WIDE RIGHT-OF-WAY); THENCE SOUTHEASTERLY ALONG SAID RIGHT-OF-WAY LINE TO THE INTERSECTION WITH THE NORTHWESTERLY RIGHT-OF-WAY LINE OF SE INDIAN STREET (A 100 FOOT WIDE RIGHT-OF-WAY), ALSO BEING THE INTERSECTION WITH THE SOUTHWESTERLY PROJECTION OF THE SOUTHEASTERLY LINE OF SAID BLOCK 225; THENCE SOUTHWESTERLY ACROSS SAID F.E.C. RAILROAD RIGHT-OF-WAY TO THE NORTHEASTERLY CORNER OF LOT 65, PORT SEWALL, AS RECORDED IN PLAT BOOK 3, PAGE 7, PUBLIC RECORDS OF PALM BEACH (NOW MARTIN) COUNTY, FLORIDA, ALSO BEING A POINT ON THE WESTERLY RIGHT-OF-WAY LINE OF SAID F.E.C. RAILROAD; THENCE SOUTHEASTERLY ALONG SAID RIGHT-OF-WAY LINE TO THE INTERSECTION WITH THE SOUTHWESTERLY PROJECTION OF THE SOUTHERLY LINE OF LOT 52, BLOCK 5, SAID GOLDEN GATE; THENCE NORTHEASTERLY ALONG SAID SOUTHWESTERLY PROJECTION TO THE INTERSECTION WITH THE WESTERLY LINE OF LOT 149, SAID BLOCK 5; THENCE NORTHWESTERLY ALONG SAID WESTERLY LINE OF SAID LOT 149 TO THE NORTHERLY LINE OF SAID LOT 149; THENCE NORTHEASTERLY ALONG SAID NORTHERLY LINE OF SAID LOT 149, TO THE INTERSECTION WITH THE WESTERLY RIGHT-OF-WAY LINE OF SE DIXIE HIGHWAY (C.R.-A-1-A);

(CONTINUED ON SHEET 3)

NOTE: THIS IS NOT A SURVEY. THIS SHEET IS NOT VALID WITHOUT SHEETS 1, 3, 4 AND 5.

SKETCH AND DESCRIPTION
GOLDEN GATE CRA – BOUNDARY
MARTIN COUNTY, FLORIDA

SUPERVISED BY : TMW

DRAWN BY : JMM SCALE : N/A

DATE : 10/14/2020

DRAWING # 20-007C

MARTIN COUNTY, STUART, FLORIDA

2401 S.E. MONTEREY ROAD PHONE NO. 772-288-5927

DWG. NAME : 20-007C.DWG M.C. PROJ. NO. 20-007C SHEET NO. 3 OF 5

DESCRIPTION

(CONTINUED FROM SHEET 2)

THENCE CONTINUE NORTHEASTERLY ACROSS SAID SE DIXIE HIGHWAY TO THE NORTHEASTERLY CORNER OF THE RIGHT-OF-WAY DONATION RECORDED IN OFFICIAL RECORDS BOOK 827, PAGE 1107, PUBLIC RECORDS, MARTIN COUNTY, FLORIDA, ALSO BEING A POINT ON THE INTERSECTION WITH THE SOUTHERLY RIGHT-OF-WAY LINE OF SE KENSINGTON STREET, ACCORDING TO SAID PLAT OF GOLDEN GATE; THENCE NORTHEASTERLY ALONG SAID SOUTHERLY RIGHT-OF-WAY LINE OF SE KENSINGTON STREET TO THE SOUTHEASTERLY PROJECTION OF THE EASTERLY RIGHT-OF-WAY LINE OF SE HEMLOCK AVENUE (PLATTED AS 8TH STREET) ACCORDING TO SAID PLAT OF GOLDEN GATE; THENCE NORTHWESTERLY ALONG SAID PROJECTION OF THE EASTERLY RIGHT-OF-WAY LINE OF SE HEMLOCK AVENUE (PLATTED 8TH STREET) ACROSS SAID SE KENSINGTON STREET TO THE INTERSECTION WITH THE NORTHERLY RIGHT-OF-WAY OF SAID SE KENSINGTON STREET; THENCE CONTINUE NORTHWESTERLY ALONG SAID EASTERLY RIGHT-OF-WAY LINE OF SE HEMLOCK AVENUE TO THE INTERSECTION WITH THE SOUTHERLY RIGHT-OF-WAY LINE OF SE ST. LUCIE BOULEVARD (PLATTED AS ST. LUCIE AVE.); THENCE CONTINUE NORTHWESTERLY ALONG THE NORTHWESTERLY PROJECTION OF SAID EASTERLY RIGHT-OF-WAY LINE ACROSS SAID SE ST. LUCIE BOULEVARD (PLATTED AS ST. LUCIE AVE.) TO THE INTERSECTION WITH THE NORTHERLY RIGHT-OF-WAY LINE OF SAID SE ST. LUCIE BOULEVARD (PLATTED AS ST. LUCIE AVE.); THENCE CONTINUE NORTHEASTERLY ALONG THE EASTERLY RIGHT-OF-WAY LINE OF SAID SE ST. LUCIE BOULEVARD (PLATTED AS 8TH STREET) TO THE INTERSECTION WITH THE WESTERLY LINE OF WILLOUGHBY CREEK; THENCE NORTHERLY ACROSS SAID WILLOUGHBY CREEK TO THE INTERSECTION WITH THE EASTERLY LINE OF SAID WILLOUGHBY CREEK, ALSO BEING THE SOUTHWESTERLY BOUNDARY LINE OF LOT W44, SAID PORT SEWALL, ACCORDING TO THE OFFICIAL MAP SEWALL'S POINT LAND COMPANY REVISED; THENCE MEANDER NORTHWESTERLY ALONG SAID EASTERLY LINE OF WILLOUGHBY CREEK TO THE SOUTHERLY RIGHT-OF-WAY OF SE ST LUCIE BOULEVARD; THENCE CONTINUE NORTHWESTERLY ACROSS SAID SE ST LUCIE BOULEVARD TO THE INTERSECTION OF THE NORTHERLY RIGHT-OF-WAY LINE OF SAID SE ST LUCIE BOULEVARD WITH THE EASTERLY LINE OF SAID WILLOUGHBY CREEK;

(CONTINUED ON SHEET 4)

NOTE: THIS IS NOT A SURVEY. THIS SHEET IS NOT VALID WITHOUT SHEETS 1, 2, 4 AND 5.

SKETCH AND DESCRIPTION
GOLDEN GATE CRA – BOUNDARY
MARTIN COUNTY, FLORIDA

SUPERVISED BY : TMW

DRAWN BY : JMM SCALE : N/A

DATE : 10/14/2020

DRAWING # 20-007C

MARTIN COUNTY, STUART, FLORIDA

2401 S.E. MONTEREY ROAD PHONE NO. 772-288-5927

DWG. NAME : 20-007C.DWG M.C. PROJ. NO. 20-007C SHEET NO. 4 OF 5

DESCRIPTION

(CONTINUED FROM SHEET 3)

THENCE CONTINUE MEANDERING NORTHERLY, WESTERLY, AND NORTHWESTERLY ALONG SAID EASTERLY LINE OF WILLOUGHBY CREEK TO THE INTERSECTION WITH THE SOUTH LINE OF BLOCK 43, ACCORDING TO SAID PORT SEWALL, AS RECORDED IN PLAT BOOK 3, PAGE 8, PUBLIC RECORDS, PALM BEACH (NOW MARTIN) COUNTY, FLORIDA; THENCE WESTERLY TO THE INTERSECTION WITH THE SOUTHWEST CORNER OF SAID BLOCK 43; THENCE NORTHWESTERLY ALONG THE WESTERLY LINE OF SAID BLOCK 43, A DISTANCE OF 64.00 FEET; THENCE WESTERLY ON A LINE THAT IS 64.00 FEET NORTHERLY OF AND PARALLEL TO THE NORTHERLY RIGHT-OF-WAY LINE OF SE NORMAND STREET TO THE WESTERLY LINE OF BLOCK 45, SAID PORT SEWALL; THENCE NORTHERLY ALONG SAID WESTERLY LINE OF SAID BLOCK 45, A DISTANCE OF 61.00 FEET; THENCE WESTERLY ALONG A LINE THAT IS 125.00 FEET NORTHERLY OF AND PARALLEL TO THE NORTHERLY RIGHT-OF-WAY LINE OF SAID SE NORMAND STREET THROUGH BLOCKS 47A, 47, 49, 51, AND 53, TO THE SOUTHEAST CORNER OF LOT 7, BLOCK 55, GOLDEN GATE PARK, ACCORDING TO SAID PLAT THEREOF; THENCE NORTHERLY ALONG THE EASTERLY LINE OF SAID LOT 7, TO THE NORTHEAST CORNER OF SAID LOT 7; THENCE CONTINUE NORTHERLY TO THE SOUTHEAST CORNER OF LOT 8, BLOCK 61; THENCE CONTINUE NORTHERLY ALONG THE EASTERLY LINE OF SAID LOT 8, TO THE SOUTHEAST CORNER OF LOT 7, SAID BLOCK 61; THENCE CONTINUE NORTHERLY ALONG THE EASTERLY LINE OF SAID LOT 7, A DISTANCE OF 7.5 FEET; THENCE WESTERLY ALONG A LINE 132.5 NORTHERLY OF AND PARALLEL TO THE SOUTHERLY LINE OF SAID BLOCK 61, TO THE SOUTHEAST CORNER OF LOT 24, BLOCK 59, SAID GOLDEN GATE PARK, ALSO BEING A POINT ON THE NORTHERLY LINE OF A 15 FOOT PLATTED ALLEY WITHIN SAID BLOCK 59; THENCE WESTERLY ALONG SAID NORTHERLY LINE TO THE SOUTHWEST CORNER OF LOT 11, SAID BLOCK 59; THENCE NORTHWESTERLY TO THE NORTHEAST CORNER OF LOT 5, SAID BLOCK 59; THENCE WESTERLY ALONG THE NORTHERLY LINE OF SAID LOT 5, BLOCK 59, TO THE INTERSECTION WITH THE EASTERLY RIGHT-OF-WAY LINE OF SAID SE DIXIE HIGHWAY (C.R.-A-1-A); THENCE NORTHWESTERLY ALONG SAID EASTERLY RIGHT-OF-WAY LINE OF SE DIXIE HIGHWAY TO THE NORTHEASTERLY PROJECTION OF THE SOUTHERLY LINE OF SAID BLOCK 223, GOLDEN GATE PARK; THENCE SOUTHWESTERLY ALONG SAID NORTHEASTERLY PROJECTION ACROSS SAID SE DIXIE HIGHWAY TO THE SOUTHEASTERLY CORNER OF SAID BLOCK 223 AND THE POINT OF BEGINNING.

NOTE: THIS IS NOT A SURVEY. THIS SHEET IS NOT VALID WITHOUT SHEETS 1, 2, 3 AND 5.

SKETCH AND DESCRIPTION
GOLDEN GATE CRA – BOUNDARY
MARTIN COUNTY, FLORIDA

SUPERVISED BY : TMW

DRAWN BY : JMM SCALE : N/A

DATE : 10/14/2020

DRAWING # 20-007C

MARTIN COUNTY, STUART, FLORIDA

2401 S.E. MONTEREY ROAD PHONE NO. 772-288-5927

DWG. NAME : 20-007C.DWG M.C. PROJ. NO. 20-007C

SHEET NO. 5 OF 5

BOUNDARY

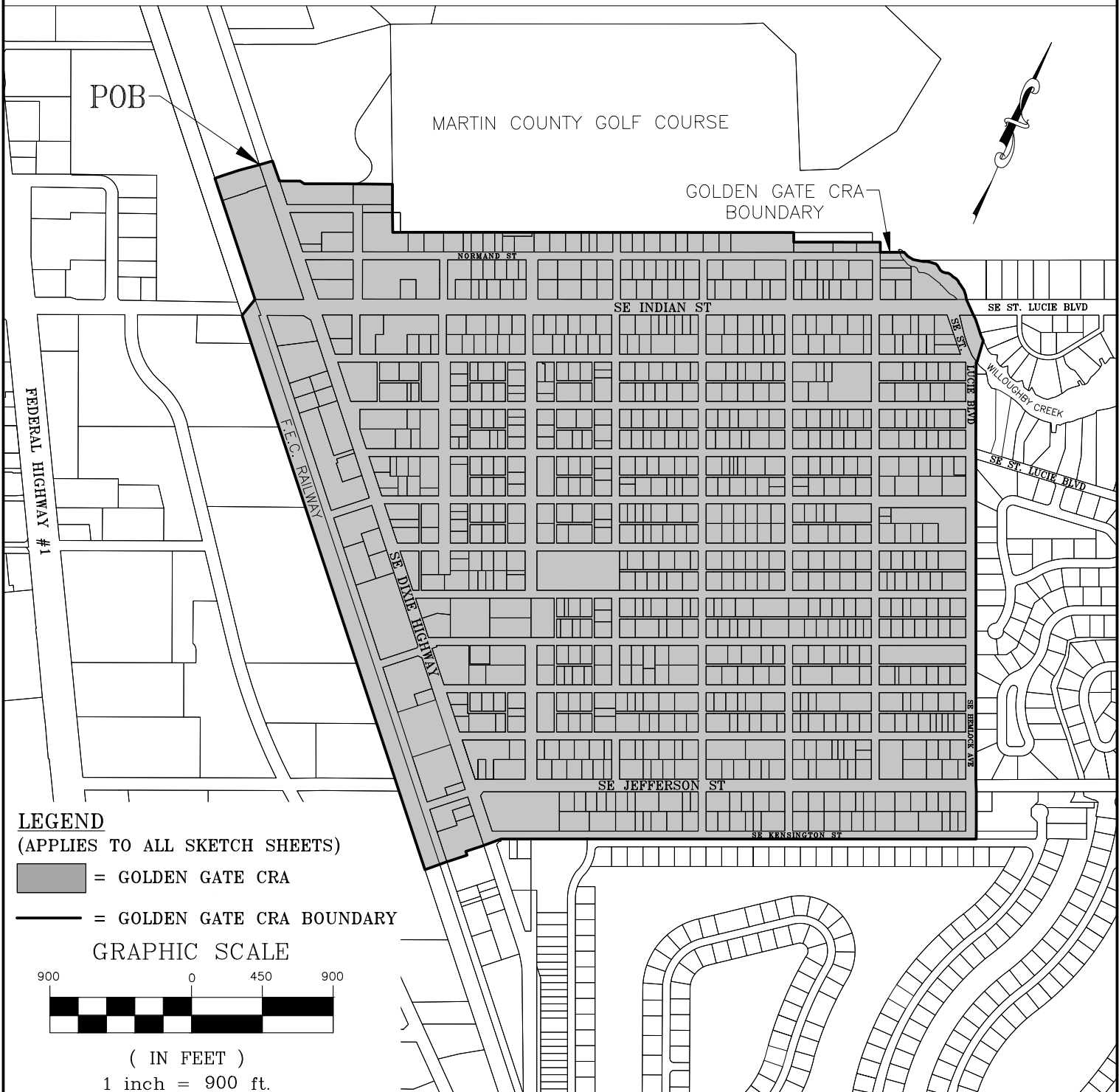

NOTE: THIS IS NOT A SURVEY. THIS SHEET IS NOT VALID WITHOUT SHEETS 1, 2, 3 AND 4.

THIS MAP IS INTENDED TO BE DISPLAYED AT A SCALE OF 1"=900' OR SMALLER.

SKETCH AND DESCRIPTION
GOLDEN GATE CRA – BOUNDARY
MARTIN COUNTY, FLORIDA

SUPERVISED BY : TMW

DRAWN BY : JMM SCALE : 1"=900'

DATE : 10/14/2020

DRAWING # 20-007C