

SOUTH FLORIDA GATEWAY
MARTIN COUNTY, FLORIDA
PARCEL "D2"
29.7 ACRES

LEGEND

- 1A – Parks & Rec Ops Offices (6,723 SF)
- 1B – Parks & Rec Warehouse (13,230 SF)
- 1C – Covered Equipment Storage (10,000 SF)
- 1D – Parks & Rec Lay-Down Area (30,000 SF)
- 2A – General Services Offices 2,988 SF
- 2B – Conference Center / Meeting Rooms
- 2C – Courtyard / Exterior Meeting Space
- 2D – Personal Vehicles (Employees Parking)
- 3A – Traffic Ops Offices (3,364 SF)
- 3B – Traffic Ops Workshop (3,100 SF)
- 3C – Traffic Ops Storage (5,000 SF)
- 3D – Traffic Sign Lay-Down Area (10,000 SF)
- 4A – Fleet Maintenance Offices (2,950 SF)
- 4B – Parts Storage (3,500 SF)
- 4C – Pull-Through Maintenance Bays (10,780 SF)
- 4D – Vehicle Maintenance Storage (3,850 SF)
- 4E – Parking & Staging Area (75,141 SF)
- 5A – Office Trades (2,988 SF)
- 5B – Trades Warehouse (9,765 SF)
- 6A – Field Ops Offices (3,866 SF)
- 6B – Field Ops Warehouse (7,298 SF)
- 6C – Heavy Vehicle Parking Area (55,393 SF)
- 6D – Field Ops Lay-Down Area (87,120 SF)
- 7A – Mosquito Control Offices (2,322 SF)
- 7B – Mosquito Control Warehouse (11,550 SF)
- 7C – Secured Mosquito Control Parking (12,420 SF)
- 7D – Truck Chemical Wash Down Area
- 7E – Chicken Coop / Chicken Quarantine Area
- 8A – Fuel Depot
- 9A – Agriculture Extension Offices (8,149 SF)
- 9B – Hydroponic (1,500 SF)
- 9C – Agriculture Extension Warehouse (1,050 SF)
- 9D – Plant Propagation Area (10,000 SF)
- 10 – Coastal Management & Ecosystems Sheds
- 11 – Agency Vehicles
- 12 – Future Growth
- 13 – Security Access Gates
- 14 – Wet Retention
- 15 – Dry Retention

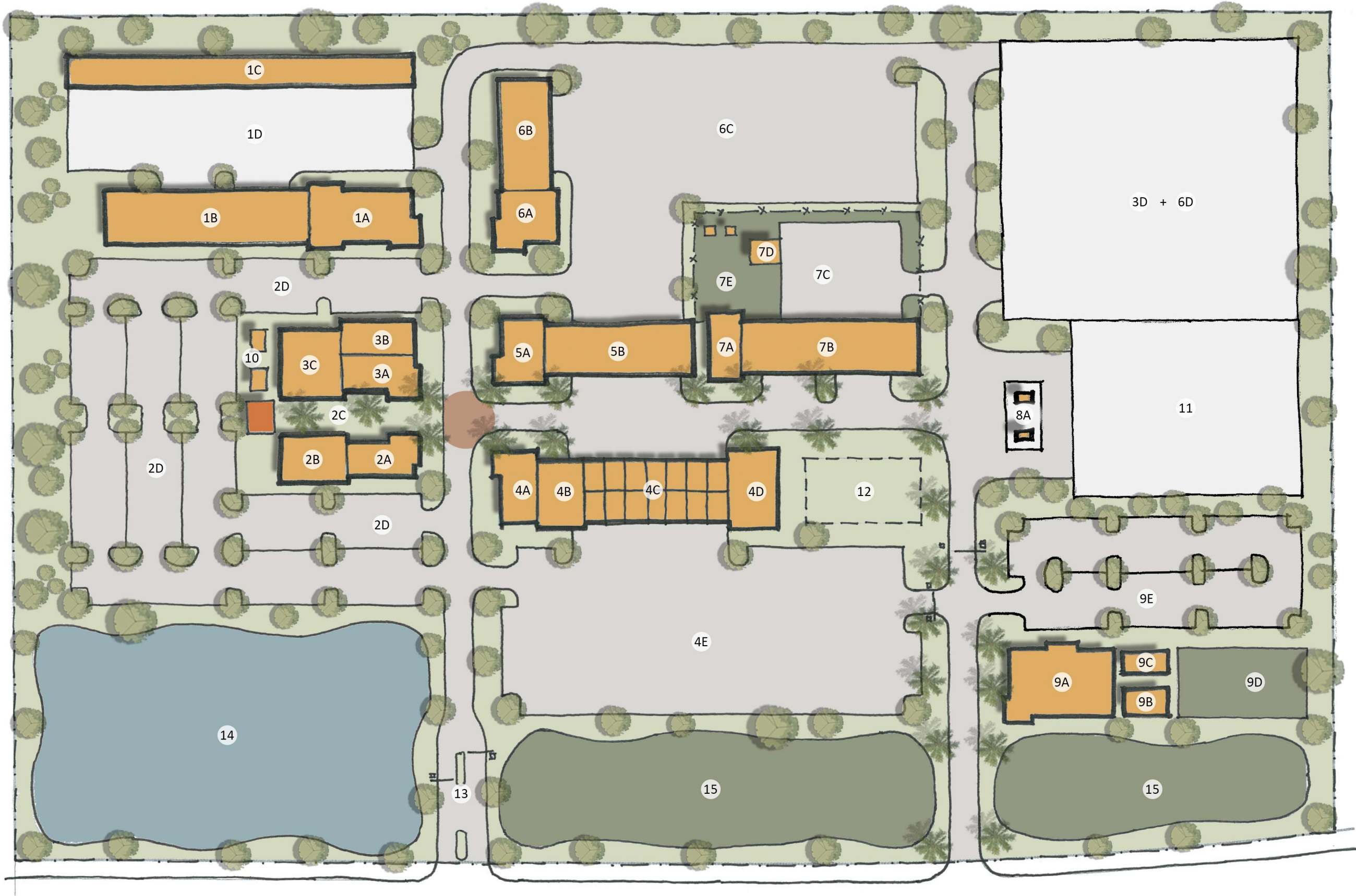

Conceptual Site Plan

South Florida Gateway PUD



CONCEPT DESIGN
PROPOSAL SHEET

B

NTS
JUNE 10, 2021

ARC3
architecture